

# LED Power Supply

- Long lasting and high reliability,
- Extra small compact housing,
- Suitable for use with desk/table lamp, floor lamp and other indoor LED applications

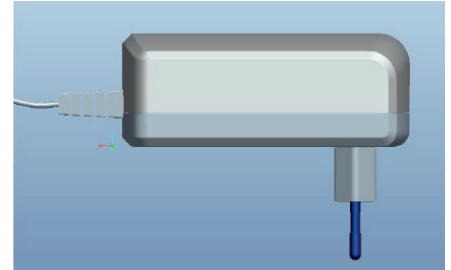

## Safety and EMC standard

- Safety according to EN 61347-1 , 61347-2-13, 62493
- RI suppression according to EN 55015 /CDN
- Line harmonics according to EN 61000-3-2
- Immunity according to EN 61547

## Approval marks



Item	Value   Unit   Remarks
------	------------------------

### 1. Input

Nominal voltage	220 – 240 VAC
Nominal frequency	50 - 60 Hz
AC voltage range	200 – 264 VAC Permitted voltage range
DC voltage range	NA V
Maximum voltage	264 V
Nominal current	180 mA 230V @ 0W load
Total Harmonic Distortion (THD)	NA
Power factor	0.9 Full load, 230 V, 50 Hz
Efficiency	>85 % Full load, 230 V, 50 Hz, typical
No-load power	< 0.5 W 230V, typical
Stand-by power	NA W
Power loss	5.3W at 230V input @ 30W load max.
Input power	35.3W at 230V input @ 30W load max.
Protection class	II
Inrush current	< 5 A twidth = 100 µs typical (measured at 50% Ipeak)

### 2. Output

Nominal voltage range	12VDC
Maximum voltage	13VDC Open circuit
Nominal current range	2500 mA
Current accuracy	+/- 5 %
Nominal power range	0-30 W Partial Load.
Maximum power	30 W Ta ≤ 40°C,
Safety isolation	SELV-equivalent 3.000 kVrms . Touch current < 0.7 mA

## ECO-12VD30

### 3. Environment

Ambient temperature range $t_a$	-20 ... +40°C
Maximum case temperature $t_c$	75°C Measured on $t_c$ point indicated of the product label
Max. Case temp. in fault condition	110 °C
Storage temperature range	-25 ... +75 °C Cool down before operating
Relative humidity	5 ... 80 % Not condensing
Surge transient protection	1 kV L/N acc. IEC 61000-3-2 (ANSI C62.41 Cat.A ...)
Environmental rating	Indoor
IP rating	IP 20
Mains switching cycles	> 50'000
Expected lifetime	30'000 @ $t_c = 75^\circ\text{C}$ , B10
	50'000 @ $t_c = 65^\circ\text{C}$ , B10

### 4. Protection

Overheating protection	yes, automatic reversible
Overload protection	yes, automatic reversible
Short-circuit protection	yes, automatic reversible
Hot plug-in protection	No, Hot plug-in or secondary switching of LEDs is not permitted and may cause a very high current to the LEDs.

### 5. Dimension | Weight

Dimensions	95x55x37mm
Weight	NA
Max. cable length	2M
Cable crosssection, input side	NA
Cable crosssection, output side	0.2 ... 1.5 mm <sup>2</sup>

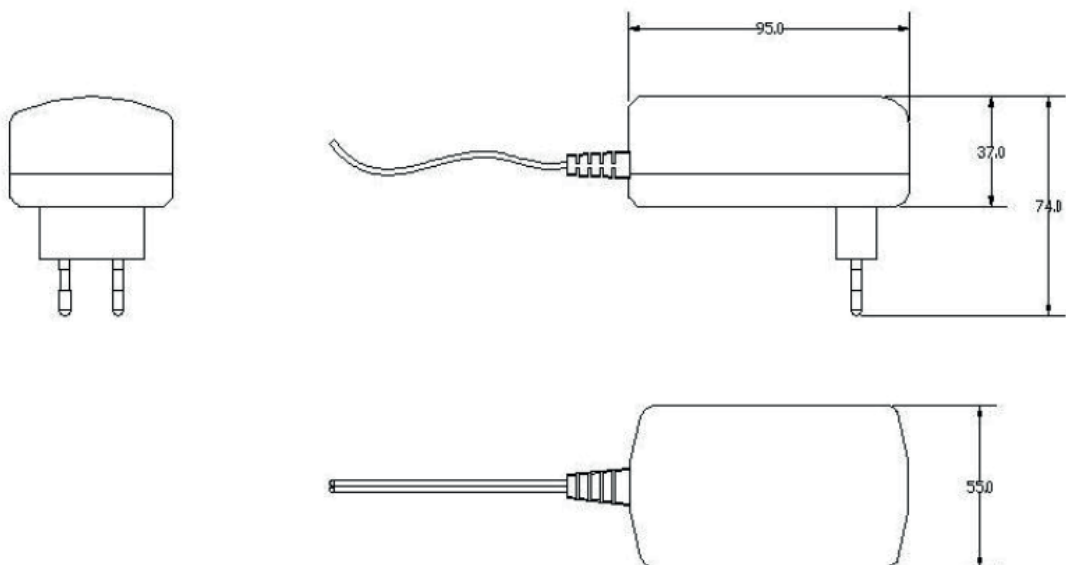

## ECO-12VD30

### 6.1 Variable Input Vs Efficiency

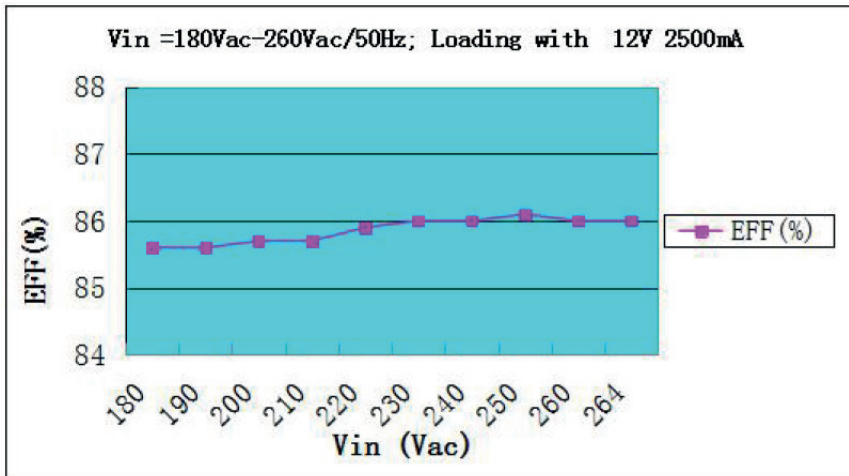

### 6.2 Variable Input Vs Vout Measurement

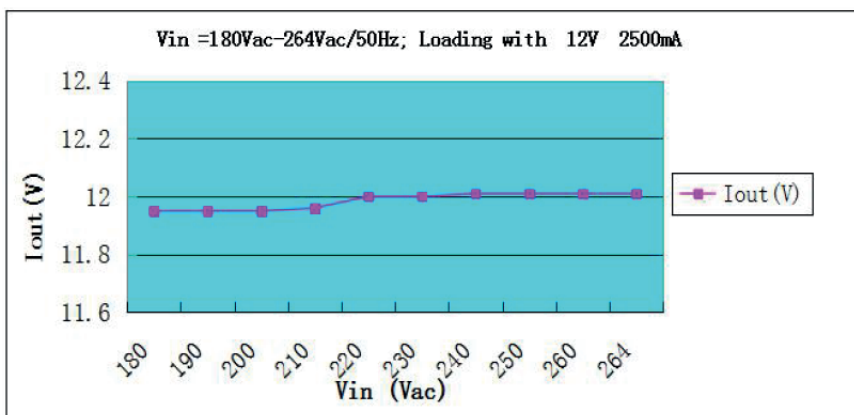

### 6.3 Variable Input Vs PF Measurement

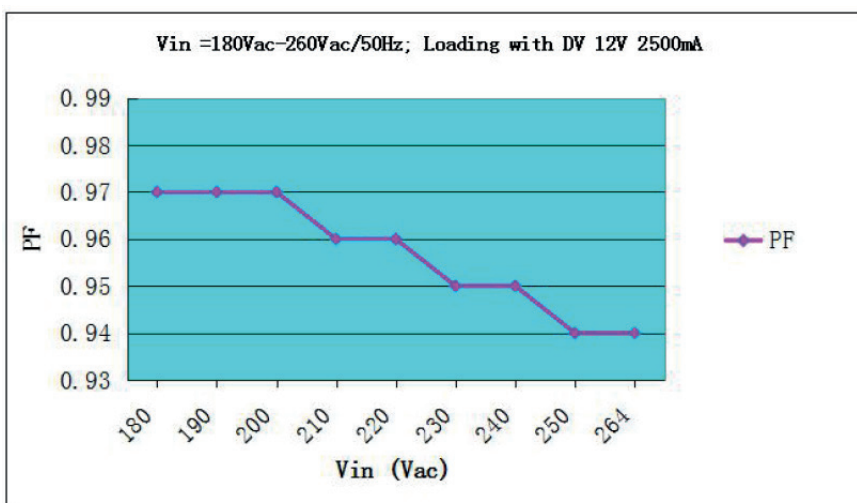

## 7. Disclaimer

The information in this data sheet subject to change without notice,  
 Always make sure to use the most recent release, or consult with us before your final selection.